

- COMPRESSOR ASSY:
1. OPERATING SPEED: 800-1000r/min (MAXIMUM SPEED 5000r/min)
 2. DIRECTION OF ROTATION: CLOCK WISE
 3. WEIGHT: 21.8kg
 4. REFRIGERANT: HFC-134a
 5. LUBRICANT: PAG 1100±100m²

- COMPRESSOR:
1. MODEL: HCS-48
 2. CYLINDER: 10-Φ42X34.7
 3. DISPLACEMENT: 480cm³/rev
 4. LEAKAGE TEST: ADDITIONAL TABLE
 5. GAS LEAK: 30g/y

- MAGNETIC CLUTCH:
1. RATED VOLTAGE: DC 24V
 2. SHAPE OF THE BELT: 3B
 3. STATIC TORSION: ABOVE 120N.m (12kgf.m)
 4. WATTAGE: 48W (DC24V2.0A) (25° C)
MINIMUM ATTRACTING VOLTAGE:
BELOW 21V (90° C)
 5. THERMAL RESISTANCE: AT 100° C, DC30V ELECTRIFY SUCCESSIVELY
 6. WEIGHT: 6.8kg

- NOTE FOR COMPRESSOR INSTALLATION:
1. INCLINATION AT INSTALLATION SHOULD BE < 15° IN LATERAL DIRECTION; < 5° FOR FRONT LIFTING; AND NO LIFTING FOR BACKSIDE;
 2. DURING TRANSPORTATION, COMPRESSOR SHOULD NOT BE INCLINED BY 45° IN BOTH LATERAL AND LONGITUDINAL DIRECTIONS; BEFORE INSTALLATION, COMPRESSOR SHOULD BE PLACED HORIZONTALLY FOR MORE THAN 10 MINUTES;
 3. REQUIREMENTS FOR THE BOLT TORSIONS:
FIXED BRACKET BOLT: 36-50N.M
FIXED LINKER BOLT: 20-24N.M

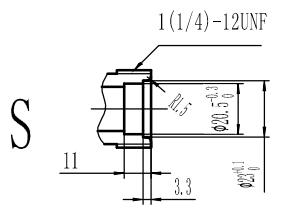
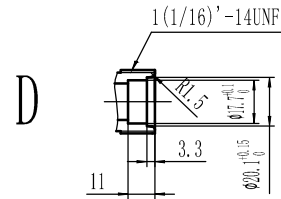
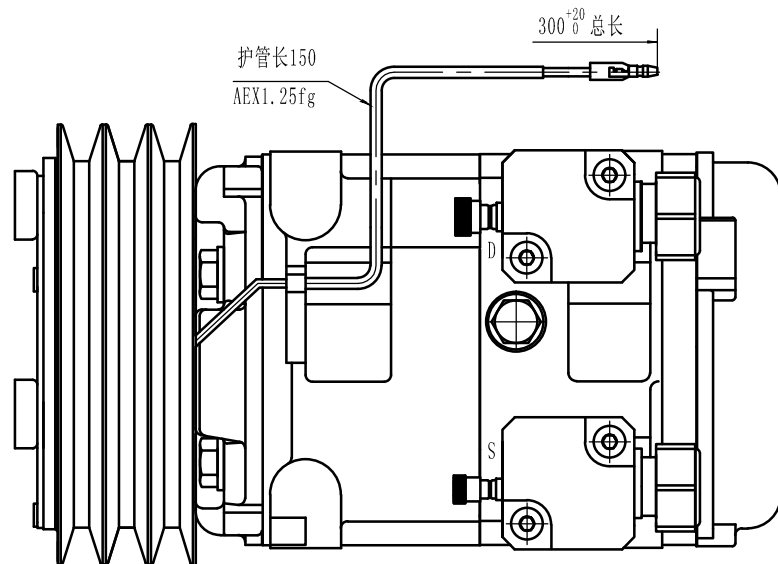

ITEM	UNIT	HIGH PRESSURE	LOW PRESSURE
		SIDE	SIDE
RESISTANT	MPa	4.4	2.2
PRESSURE	(Kgf/cm ² G)	(45)	(22.5)

						HCS-48		HZL	
标记	发数	分区	更改文件号	签名	年、月、日	除段标记		重量	比例
设计	曾佑华	2018.1.11	标准化						1:1
审核									
工艺			批准			共 张 第 张		305160-1950	